

No. 2008

THE COMMONWEALTH OF MASSACHUSETTS

FEE 200 Ad

BOARD OF HEALTH

Town of Newbury

APPLICATION FOR DISPOSAL SYSTEM CONSTRUCTION PERMIT

Application for a Permit to Construct ( ) Repair (✓) Upgrade ( ) Abandon ( ) -  Complete System  Individual Components

<u>12 Green St.</u> Location	<u>Wilhemina Lunt</u> Owner's Name
<u>U-9</u> Map/Parcel #	<u>12 Green St.</u> Address
<u>74</u> Lot #	<u>(978) 465-<del>0150</del></u> Telephone #
<u>T.L. Norton</u> Installer's Name	<u>Millennium Engineering, dnc.</u> Designer's Name
<u>35 Phillips Dr.</u> Address	<u>62 Elm St. Salisbury</u> Address
<u>465-7651</u> Telephone #	<u>(978) 463-8980</u> Telephone #

Type of Building: Residential Lot Size 19,055 Sq. feet  
 Dwelling — No. of Bedrooms 3 Garbage Grinder (N)  
 Other — Type of Building \_\_\_\_\_ No. of persons \_\_\_\_\_ Showers ( ) Cafeteria ( )  
 Other fixtures \_\_\_\_\_

Design Flow (min. required) 330 gpd Calculated design flow \_\_\_\_\_ gpd Design flow provided 330 gpd

Plan: Date May 2, 2001 Number of sheets 3 Revision Date \_\_\_\_\_

Title Proposed Local Upgrade of Existing Septic System

Description of Soil(s) \_\_\_\_\_  
 Soil Evaluator Form No. \_\_\_\_\_ Name of Soil Evaluator T. McGrath Date of Evaluation 3/26/01 & 4/19/01

DESCRIPTION OF REPAIRS OR ALTERATIONS Install 1500 gal. tank, 1000 gal. pump chamber, & pressure distribution leach field.

The undersigned agrees to install the above described Individual Sewage Disposal System in accordance with the provisions of TITLE 5 and further agrees not to place the system in operation until a Certificate of Compliance has been issued by the Board of Health.

Signed Therese L. Norton Date 9/28/01

Inspections \_\_\_\_\_  
 \_\_\_\_\_  
 \_\_\_\_\_

FORM 1 - APPLICATION FOR DSCP DEP APPROVED FORM 5/96

No. 2008

THE COMMONWEALTH OF MASSACHUSETTS

FEE PD

Newbury BOARD OF HEALTH

CERTIFICATE OF COMPLIANCE

Description of Work:  Individual Component(s)  Complete System

The undersigned hereby certify that the Sewage Disposal System: Constructed ( ) Repaired ( ) Upgraded ( ) Abandoned ( )

by: T.L. Norton  
 at 12 GREEN ST M U-9 lot 74

has been installed in accordance with the provisions of 310, CMR 15.00 (Title 5) and the approved design plans/as-built plans relating to application No. 2008 dated 5/2/2001 Approved Design Flow 330 (gpd)

Installer Therese L. Norton

Designer: SEE ATTACHED Inspector Wendy Hill My Date 12/3/01

The issuance of this certificate shall not be construed as a guarantee that the system will function as designed.

FORM 3 - CERTIFICATE OF COMPLIANCE DEP APPROVED FORM 5/96

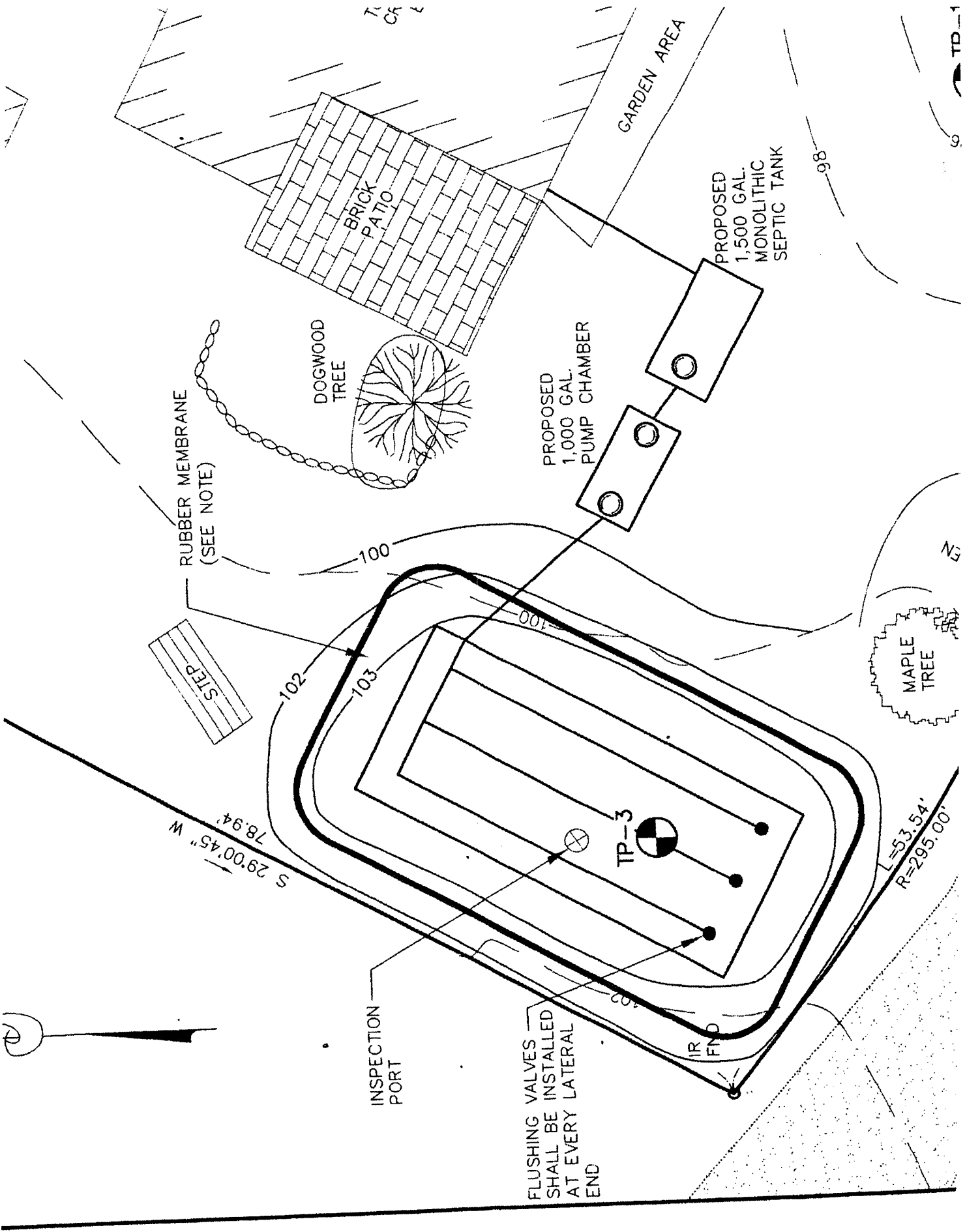

RUBBER MEMBRANE  
(SEE NOTE)

DOGWOOD  
TREE

BRICK  
PATIO

GARDEN AREA

PROPOSED  
1,000 GAL.  
PUMP CHAMBER

PROPOSED  
1,500 GAL.  
MONOLITHIC  
SEPTIC TANK

STEP

MAPLE  
TREE

INSPECTION  
PORT

FLUSHING VALVES  
SHALL BE INSTALLED  
AT EVERY LATERAL  
END

TP-3

IR  
FND

# SYSTEM TIES

SCALE: 1" = 20'

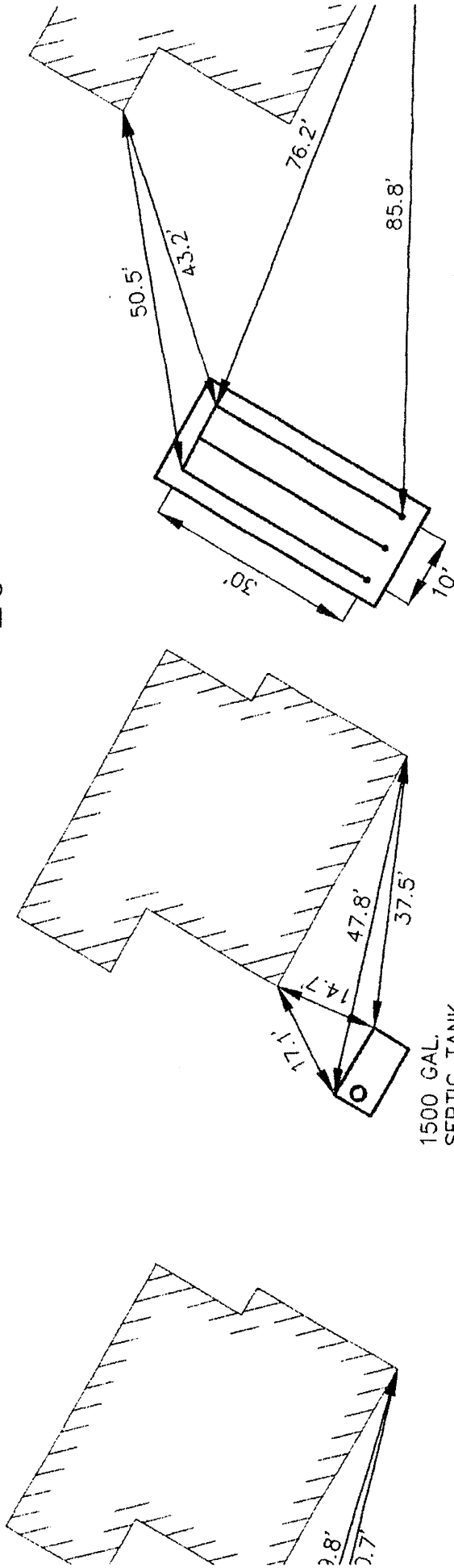

# SYSTEM PROFILE

N.T.S.

WATER-TIGHT RISER, FRAME &  
COVER TO WITHIN 6" FROM  
FINISHED GRADE.



WT